

Ethernet 10Base-T/AUI Repeater

MF-625



AUI



RJ-45



Application

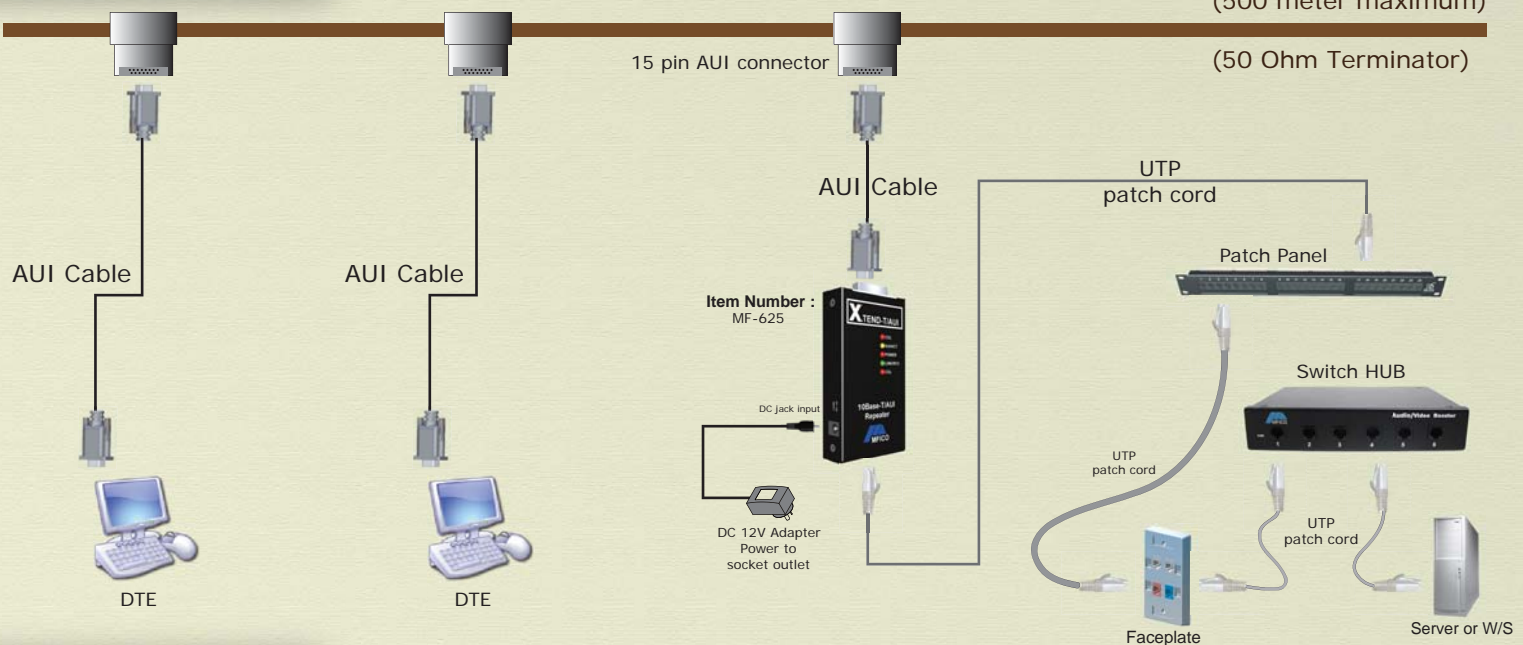

Description

Ethernet 10Base-T/AUI Repeater to connect your existing Thick Ethernet Network environment to a 10Base-T UTP network. The converter repeats signals from the Thick Ethernet to a suitable form for transmission over UTP wires to the 10Base-T HUB or similar HUB.

Specifications

Interface:	1xDB-15 female to 10 Base-5(AUI) 1xRJ-45 Jack to 10 Base-T
Cable length:	500 m max. per Thick Ethernet 100 m max. per UTP cables
LEDs:	POWER, COL, LINK, ACT/RCV
Temperature:	0 to 55 (standard operating)
Humidity:	10 to 90% (non-condensing)
Standard:	IEEE 802.3 10Base-T/AUI Ethernet
EMI:	Meets FCC Class A Subpart B of Part15 Requirement
Technique:	Baseband
Dimensions:	4.2" x 2.2"x 0.8"

Features

- 4 LEDs for Link, Collision, TP Receive.
- Power indicates light to troubleshooting & network maintenance.
- Includes external 12V DC/500 mA power adapter.
- Converts existing Thick Ethernet to a 10Base-T network.
- Conforms to IEEE 802.3 10 Base-T standards.

Item Number	Description
MF-625	Ethernet 10Base-T/AUI Repeater